

TENANT INDEX

1	CITIZENS BANK	3,600
2	OFFICE DEPOT	24,744
3	PETSMART	19,492
4	PRICERITE SUPERMARKET	37,581
5	AVAILABLE	7,320
6	MICHAEL'S	24,000
7	PIER 1 IMPORTS	9,975
8	TARGET	119,872
9	PAYLESS SHOE SOURCE	2,874
10	TGI FRIDAY'S	7,087

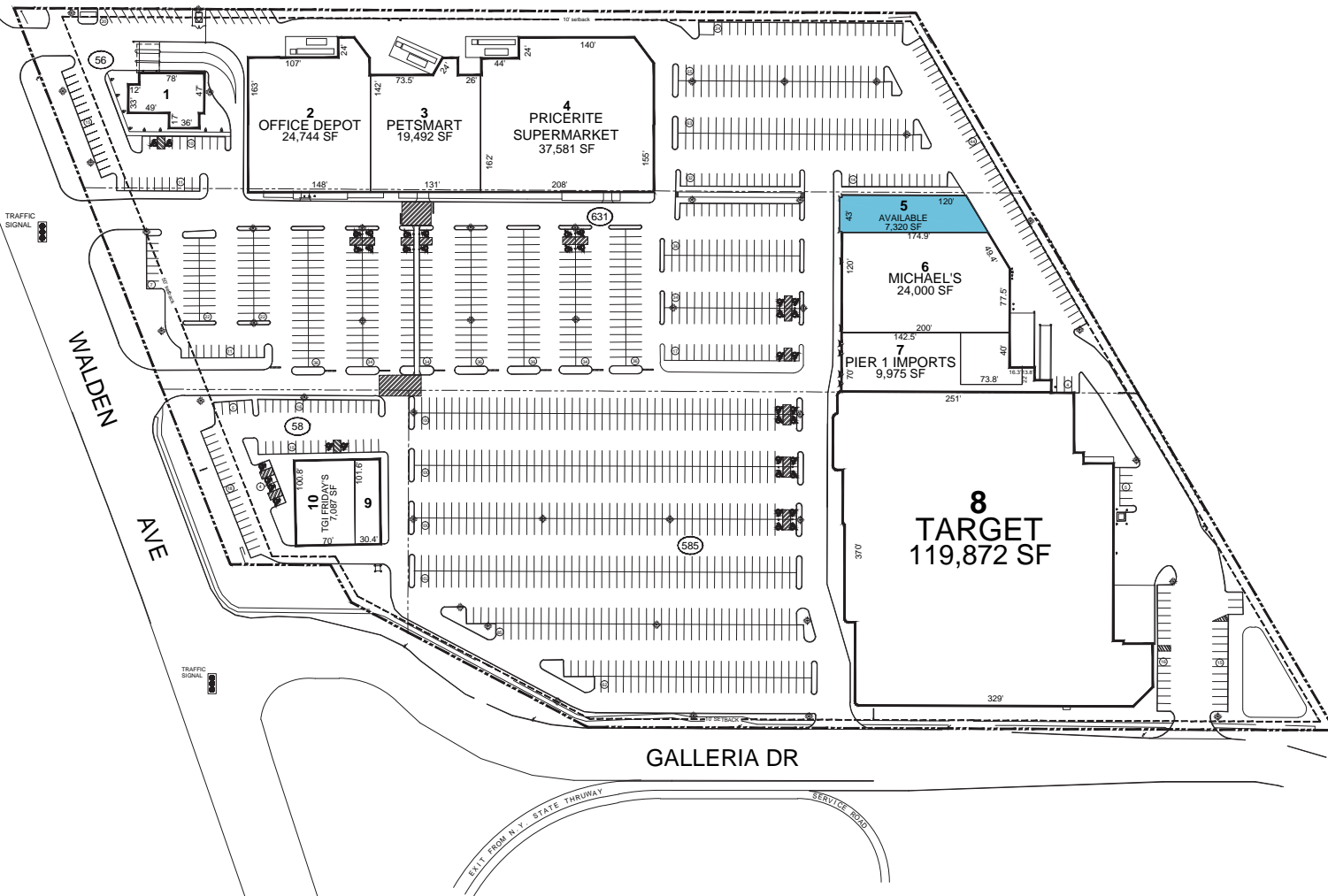

WALDEN CONSUMER SQUARE

1700-1750 Walden Ave
CHEEKTOWAGA, NY 14225

Latitude: 42.9098 , Longitude: -78.7728

AVAILABLE



THIS DRAWING IS FOR GENERAL INFORMATION PURPOSES ONLY. ANY AND ALL FEATURES, MATTERS AND OTHER INFORMATION DEPICTED HEREON OR CONTAINED HEREIN ARE FOR ILLUSTRATIVE MARKETING PURPOSES ONLY. ARE SUBJECT TO MODIFICATION WITHOUT NOTICE. ARE NOT INTENDED TO BE RELIED UPON BY ANY PART AND ARE NOT INTENDED TO CONSTITUTE REPRESENTATIONS OR WARRANTIES AS TO OWNERSHIP OF THE REAL PROPERTY DEPICTED HEREON. THE SIZE AND NATURE OF IMPROVEMENTS TO BE CONSTRUCTED (OR THAT ANY IMPROVEMENTS WILL BE CONSTRUCTED) OR THE IDENTITY OR NATURE OF ANY OCCUPANTS THEREOF.

3300 Enterprise Parkway, Beachwood, OH 44122
Fax 216 . 755 . 1500 Phone 216 . 755 . 5500